



*Safety fuel transfer
and management solutions
for professional users*



FMT Swiss AG



FMT Swiss AG is an european manufacturer for fuel and diesel transfer and professional pumping solutions.

FMT Swiss AG sells in over 30 countries : Europe, Asia, South America, Africa, Eastern countries.

Factory located in Falkenstein - Germany :

- 50 employees
- 4 CNC lathes
- Manufacturing capacity : 50 000 pumps/year
- A Swiss technical design and a german manufacturing
- A new logistic area created in 2010
- A large stock of pumps and equipments
- A efficient after sales service
- Procedure quality and endurance tests
- An innovative and famous brand
- EUN norm agreements : GNR EN590, EUN ADR....

Product line in our catalogs

More than 200 products : Pumps and accessories to transfer Fuel, Diesel, Oil, Grease, ad Blue.

Our pumps can be fitted with steel or PE tank installations.



Customized solutions

We can consider any specific request for customized pumping equipment.

We bring our knowledge and our technical experience.

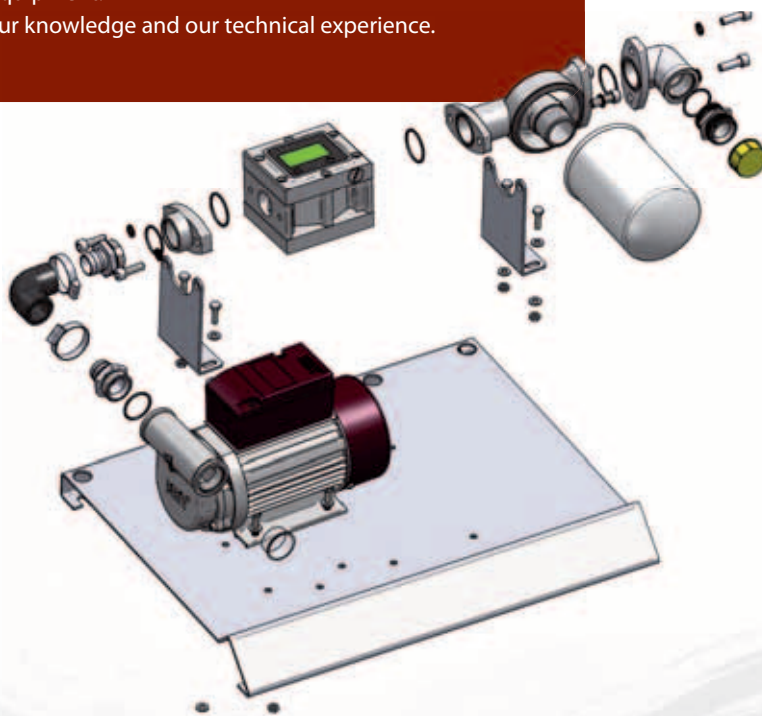



Technical advantages Fuel/Diesel pumps

- Duty cycle : continuous operation
- Industrial rotary self priming vane pump with internal by pass
- Small tolerances provide a high suction and pressure performance
- Materials guarantee an exceptional lifetime with optimized efficiency
- AISI and O'rings fittings

AISI312 body pump

PEI vanes form stability
up to 200°C
Siphon protection

Rigid mounting

O'ring fittings
No sticking
Perfect sealing

Industrial pump

Continuous operation

3 digit mechanical in line meter

Diesel filter-water

absorbing 30 microns – 100 L/min

Plate for wall or tank mounting



FMT SWISS AG O ring fitting systems

- ✓ Our pumps are tested electrically, pressure
- ✓ Recurrent testing for temperature and noise
- ✓ EU Norm warranty
- ✓ Operating instructions in English
- ✓ Qualitative packaging

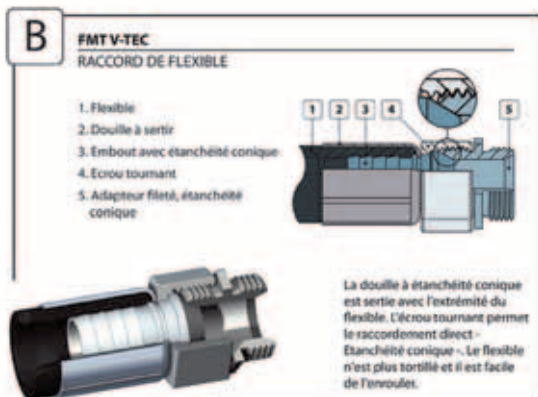
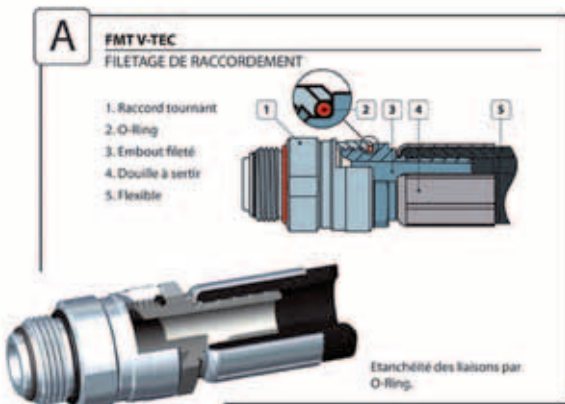

An exceptionnaly long life for most of 230V pumps:

- 3** Warranty body pump 3 years :
Outside of worn parts
- 5** Warranty electric motor 5 years :
Except break out of warranty



12/24V DC Fuel/Diesel pumps



23 012
23 012 824



23 008
23 008 824



Premaxx



23 015
23 015 824



23 009
23 009 824



23 711
23 721

12V DC pumps

Code	Kw	Voltage	Flow*	Equipment	Weight	Applications	Duty cycle	Warranty	
								Body pump**	Motor***
23 012	0,22	12V-IP54	35 L/min	Self priming vane pump with bypass – AISI G 3/4" F & G 1" M – connecting cable with battery terminal clips 3 meters – On/Off switch, siphon protection system, locking device	3,5 kg	Fuel, diesel	CONTINUOUS	2 years	3 years
23 008	0,38	12V-IP54	60 L/min	Self priming vane pump with bypass – AISI G 1" F M – connecting cable with battery terminal clips 3 meters – On/Off switch, siphon protection system, locking device	4,0 kg	Fuel, diesel	30 min	2 years	3 years

24V DC pumps

23 012 824	0,32	24V-IP54	35 L/min	Self priming vane pump with bypass – AISI G 3/4" F & G 1" M – connecting cable with battery terminal clips 3 meters – On/Off switch, siphon protection system, locking device	3,5 kg	Fuel, diesel	CONTINUOUS	2 years	3 years
23 008 824	0,67	24V-IP54	60 L/min	Self priming vane pump with bypass – AISI G 1" F M – connecting cable with battery terminal clips 3 meters – On/Off switch, siphon protection system, locking device	4,0 kg	Fuel, diesel	30 min	2 years	3 years

12V DC pumps sets

23 015	0,22	12V-IP54	35 L/min	Self priming vane pump with bypass – AISI G 3/4" F & G 1" M – connecting cable with battery terminal clips 3 meters – On/Off switch, siphon protection system, locking device + DN25 suction hose 1,6m + discharge hose 4m + foot valve with filter + aluminum mechanical nozzle valve	8,5 kg	Fuel, diesel	CONTINUOUS	2 years	3 years
23 009	0,38	12V-IP54	60 L/min	Self priming vane pump with bypass – AISI G 1" F M – connecting cable with battery terminal clips 3 meters – On/Off switch, siphon protection system, locking device + DN25 suction hose 1,6m + discharge hose 4m + foot valve with filter + aluminum mechanical nozzle valve	8,5 kg	Fuel, diesel	30 min	2 years	3 years
23 711	0,18	12V-IP44	38 L/min	Axial rotation pump PREMAXX – G 1" with battery terminal clips 3 meters – On/Off switch, siphon protection system + suction hose 1,6m + discharge hose 4m + polypropylene nozzle valve	4,5 kg	Fuel, diesel	CONTINUOUS	1 year	1 year

24V DC pumps sets

23 015 824	0,32	24V-IP54	35 L/min	Self priming vane pump with bypass – AISI G 3/4" F & G 1" M – connecting cable with battery terminal clips 3 meters – On/Off switch, siphon protection system, locking device + DN25 suction hose 1,6m + discharge hose 4m + foot valve with filter + aluminum mechanical nozzle valve	8,5 kg	Fuel, diesel	CONTINUOUS	2 years	3 years
23 009 824	0,67	24V-IP54	60 L/min	Self priming vane pump with bypass – AISI G 1" F – connecting cable with battery terminal clips 3 meters – On/Off switch, siphon protection system, locking device + DN25 suction hose 1,6m + discharge hose 4m + foot valve with filter + aluminum mechanical nozzle valve	8,5 kg	Fuel, diesel	30 min	2 years	3 years
23 721	0,24	24V-IP44	43 L/min	Axial rotation pump PREMAXX – G 1" with battery terminal clips 3 meters – On/Off switch, siphon protection system + suction hose 1,6m + discharge hose 4m + polypropylene nozzle valve	5,4 kg	Fuel, diesel	CONTINUOUS	1 year	1 year

* flow rate, free discharge
** outside of worn parts
*** except break out of warranty

Other equipments are available on our website: www.fmtag.ch

Non contractual photography



23 034



23 036



23 082



23 084



23 083



23 737

230V pumps

Code	Kw	Voltage	Flow*	Equipment	Weight	Applications	Duty cycle	Warranty	
								Body pump**	Motor***
23 034	0,37	230V-IP54	56 L/min	Self priming vane pump with bypass – AISI G 1" F – On/Off switch, siphon protection system	6,8 kg	Fuel, diesel	CONTINUOUS	3 years	5 years
23 036	0,5	230V-IP54	100 L/min	Self priming vane pump with bypass – AISI G 1" F – On/Off switch, siphon protection system	11,3 kg	Fuel, diesel	CONTINUOUS	3 years	5 years

230V set pumps with drum adapter

23 082	0,37	230V-IP54	56 L/min	Self priming vane pump with bypass – AISI G 1" F – On/Off switch, siphon protection system : set with drum adaptor DRC 2" barrel screw coupling for up to 1000 L container, foot valve with filter, DN25 suction hose 1,60m, delivery hose 4m, automatic nozzle valve,universal control nozzle storage bracket	13 kg	Fuel, diesel	CONTINUOUS	3 years	5 years
23 084	0,5	230V-IP54	100 L/min	Self priming vane pump with bypass – AISI G 1" F – On/Off switch, siphon protection system : set with drum adaptor DRC 2" barrel screw coupling foot valve with filter, DN25 suction hose 1,60m, DN 25 delivery hose 4m, automatic nozzle valve,universal control nozzle storage bracket	20 kg	Fuel, diesel	CONTINUOUS	3 years	5 years
23 083	0,37	230V-IP54	56 L/min	Self priming vane pump with bypass – AISI G 1" F – On/Off switch, siphon protection system : set with drum adaptor DRC 2" barrel screw coupling foot valve with filter, in-line meter 3 digits and totalisator, DN25 suction hose 1,60m, DN25 delivery hose 4m, automatic nozzle valve,universal control nozzle storage bracket	15 kg	Fuel, diesel	CONTINUOUS	3 years	5 years

230V PREMAXX set pump with drum adapter

23 737	0,32	230V-IP44	52 L/min	Axial rotation pump PREMAXX – G 1" with battery terminal clips 3 meters – On/Off switch, siphon protection system + suction hose 1,6m + discharge hose 4m+automatic nozzle valve	4,5 kg	Fuel, diesel	CONTINUOUS	1 year	1 year
--------	------	-----------	----------	--	--------	--------------	------------	--------	--------

* flow rate, free discharge
 ** outside of worn parts
 *** except break out of warranty

Other equipments are available on our website: www.fmtag.ch

Non contractual photography



12V – 24V DC Fuel/Diesel plate sets

New 2011 :
 Autonomy + Safety :
 Electrical connection to battery 12 or 24V DC
 Low consumption of energy
 Diesel filter, water absorbing integrated

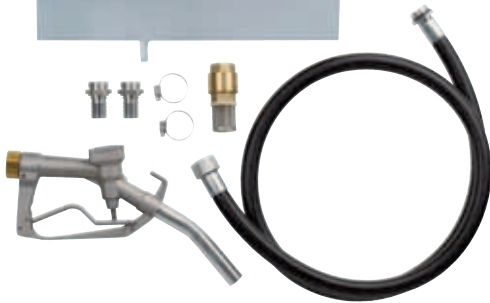

23 015 410
23 015 411



23 015 417
23 015 418



Quality On/Off switch
Thermal protection



3m Battery cable with terminal clips

12–24V DC ECO plate sets for wall mounting

Code	Kw	Voltage	Flow*	Equipment	Weight	Applications	Duty cycle	Warranty	
								Body pump**	Motor***
23 015 410	0,22	12V-IP54	35 L/min	Plate pump set with self priming vane pump 12VDC with bypass – AISI G 3/4" F & G 1" M – battery cable with 3m terminal clips, On/Off switch, anti siphoning system, locking device – Filtration set 100 L/min – DN19 delivery hose 4m with MM 1" fittings , aluminum mechanical nozzle valve	15 kg	Fuel, diesel	CONTINUOUS	2 years	3 years
23 015 411	0,22	24V-IP54	35 L/min	Plate pump set with self priming vane pump 24VDC with bypass – AISI G 3/4" F & G 1" M – battery cable with 3m terminal clips, On/Off switch, anti siphoning system, locking device – Filtration set 100 L/min – DN19 delivery hose 4m with MM 1" fittings , aluminum mechanical nozzle valve	15 kg	Fuel, diesel	CONTINUOUS	2 years	3 years

12–24V DC PREMIUM plate sets for wall mounting

23 015 417	0,22	12V-IP54	35 L/min	Plate pump set with self priming vane pump 12VDC with bypass – AISI G 3/4" F & G 1" M – battery cable with 3m terminal clips, On/Off switch, anti siphoning system, locking device – in-line meter 3 digits with totalisator , Filtration set 100 L/min – DN19 delivery hose 4m with MM 1" fittings , automatic nozzle valve	17 kg	Fuel, diesel	CONTINUOUS	2 years	3 years
23 015 418	0,22	24V-IP54	35 L/min	Plate pump set with self priming vane pump 24VDC with bypass – AISI G 3/4" F & G 1" M – battery cable with 3m terminal clips, On/Off switch, anti siphoning system, locking device – in-line meter 3 digits with totalisator , Filtration set 100 L/min – DN19 delivery hose 4m with MM 1" fittings , automatic nozzle valve	17 kg	Fuel, diesel	CONTINUOUS	2 years	3 years

* flow rate, free discharge
 ** outside of worn parts
 *** except break out of warranty

Other equipments are available on our website : www.fmtag.ch

Non contractual photography

230V fuel/Diesel plate pumps sets



Wall or tank mounting



230V ECO plate sets for wall mounting

Code	Kw	Voltage	Flow*	Equipment	Weight	Applications	Duty cycle	Warranty	
								Body pump**	Motor***
23 014 443	0,37	230V-IP54	56 L/min	Plate pump Eco set with self priming vane pump with bypass – AISI G 1" F – On/Off switch, anti siphoning system – O'ring fittings – Filtration set 100 L/min – DN19 delivery hose 4m with MF 1" fittings , automatic nozzle valve	14 kg	Fuel, diesel	CONTINUOUS	3 years	5 years

230V STANDARD plate sets for wall mounting

23 014 448	0,37	230V-IP54	56 L/min	Plate pump set with self priming vane pump with bypass – AISI G 1" F – On/Off switch, anti siphoning system – O'ring fittings -in-line meter 3 digits with totalisator, Filtration set 100 L/min – DN19 delivery hose 4m with MF 1" fittings , automatic nozzle valve	18 kg	Fuel, diesel	CONTINUOUS	3 years	5 years
23 014 447	0,37	230V-IP54	56 L/min	Plate pump set with self priming vane pump with bypass – AISI G 1" F – On/Off switch, anti siphoning system – O'ring fittings -in-line meter 3 digits with totalisator, Filtration set 100 L/min – DN19 delivery hose 6m with MF 1" fittings , automatic nozzle valve	19 kg	Fuel, diesel	CONTINUOUS	3 years	5 years
23 017 447	0,5	230V-IP54	100 L/min	Plate pump set with self priming vane pump with bypass – AISI G 1" F – On/Off switch, anti siphoning system – O'ring fittings -in-line meter 3 digits with totalisator, Filtration set 100 L/min – DN25 delivery hose 6m with MF 1" fittings , automatic nozzle valve	26 kg	Fuel, diesel	CONTINUOUS	3 years	5 years

230V PREMIUM plate sets for wall mounting

23 014 397	0,37	230V-IP54	56 L/min	Plate pump set with self priming vane pump with bypass – AISI G 1" F – On/Off switch, anti siphoning system – O'ring fittings -in-line meter 3 digits with totalisator, Filtration set 100 L/min – DN19 delivery hose 6m with MF 1" fittings , automatic nozzle valve, universal control nozzle storage bracket	20 kg	Fuel, diesel	CONTINUOUS	3 years	5 years
23 017 393	0,5	230V-IP54	100 L/min	Plate pump set with self priming vane pump with bypass – AISI G 1" F – On/Off switch, anti siphoning system – O'ring fittings -in-line meter 3 digits with totalisator, Filtration set 100 L/min – DN25 delivery hose 6m with MF 1" fittings , automatic nozzle valve, universal control nozzle storage bracket	27 kg	Fuel, diesel	CONTINUOUS	3 years	5 years

230V INDUSTRIAL plate sets for wall mounting

23 014 394	0,37	230V-IP54	56 L/min	Industrial Plate pump set with self priming vane pump with bypass – AISI G 1" F – On/Off switch, anti siphoning system – O'ring fittings -in-line digital aluminum meter 5 digits with totalisator, Filtration set 100 L/min – DN19 delivery hose 6m with MF 1" fittings , automatic nozzle valve, universal control nozzle storage bracket	25 kg	Fuel, diesel	CONTINUOUS	3 years	5 years
23 017 394	0,5	230V-IP54	100 L/min	Industrial Plate pump set with self priming vane pump with bypass – AISI G 1" F – On/Off switch, anti siphoning system – O'ring fittings -in-line digital aluminum meter 5 digits with totalisator, Filtration set 100 L/min – DN25 delivery hose 6m with MF 1" fittings , automatic nozzle valve, universal control nozzle storage bracket	34 kg	Fuel, diesel	CONTINUOUS	3 years	5 years

* flow rate, free discharge
 ** outside of worn parts
 *** except break out of warranty

Other equipments are available on our website : www.fmtag.ch

Non contractual photography



230V Fuel/Diesel Box filled station



Outdoor:
Duracryl protection
against sunlight and
weather



230V Box filled station

Code	Kw	Voltage	Flow*	Equipment	Weight	Applications	Duty cycle	Warranty	
								Body pump**	Motor***
23 080	0,37	230V-IP54	56 L/min	Box filling station with self priming vane pump with bypass – AISI G 1" F – On/Off switch, anti siphoning system – O'ring fittings -in-line meter 3 digits with totalisator – DN19 delivery hose 6m with MF 1 " fittings , automatic nozzle valve, nozzle storage bracket with automatic shutdown of the pump, duracryl outside protection	23 kg	Fuel, diesel	CONTINUOUS	3 years	5 years
23 470	0,5	230V-IP54	100 L/min	Box filling station with self priming vane pump with bypass – AISI G 1" F – On/Off switch, anti siphoning system – O'ring fittings -in-line meter 3 digits with totalisator – DN25 delivery hose 6m with MF 1 " fittings , automatic nozzle valve, nozzle storage bracket with automatic shutdown of the pump, duracryl outside protection	30 kg	Fuel, diesel	CONTINUOUS	3 years	5 years
23 452	0,37	230V-IP54	56 L/min	Box filling station with self priming vane pump with bypass – AISI G 1" F – On/Off switch, anti siphoning system – O'ring fittings -in-line meter 3 digits with totalisator – Filtration set 100 L/min – DN19 delivery hose 6m with MF 1 " fittings , automatic nozzle valve, nozzle storage bracket with automatic shutdown of the pump, duracryl outside protection	24 kg	Fuel, diesel	CONTINUOUS	3 years	5 years
23 472	0,5	230V-IP54	100 L/min	Box filling station with self priming vane pump with bypass – AISI G 1" F – On/Off switch, anti siphoning system – O'ring fittings -in-line meter 3 digits with totalisator – Filtration set 100 L/min – DN25 delivery hose 6m with MF 1 " fittings , automatic nozzle valve, nozzle storage bracket with automatic shutdown of the pump, duracryl outside protection	31 kg	Fuel, diesel	CONTINUOUS	3 years	5 years

Vertical column

23 070 001	-	-	-	Vertical column for Box filling station	7 kg	Fuel, diesel	-	-	-
------------	---	---	---	---	------	--------------	---	---	---

* flow rate, free discharge
** outside of worn parts
*** except break out of warranty

Other equipments are available on our website : www.fmtag.ch

Non contractual photography



23 287



23 193



19 693



Meters

Code	Kw	Voltage	Flow*	Equipment	Weight	Applications	Duty cycle	Warranty	
								Body pump**	Motor***
23 287	-	-	Max 56 L/min	Digital horizontal in line meter – NEF - 1 " GF - 1 " GM – 4 digits with 2 decimal – total summation at 99 999 L with 9 different part sums – measuring tolerance 1%	0,5 kg	Fuel, diesel, Ad blue	-	-	-
23 193	-	-	Max 120 L/min	Mechanical vibrating disc in line meter – various in-line installation - 1 " GF - 1 " GM – 3 digits daily meter – totalisator 6 digits – measuring tolerance 1%	2 kg	Fuel, diesel	-	-	-
19 692	-	-	Max 60 L/min	Digital oval gear meter in aluminum – impact safe - 1 " GF - 1 " GF DN25– 5 digits with floating decimal – total summation with 6 digits- measuring tolerance 0,5%	3 kg	Fuel, diesel, motor oil, gasoline	-	-	-
19 693	-	-	Max 100 L/min	Digital oval gear meter in aluminum – impact safe - 1 " GF - 1 " GF DN25– 5 digits with floating decimal – total summation with 6 digits - measuring tolerance 0,5%	4 kg	Fuel, diesel, motor oil, gasoline	-	-	-

23 161



23 171



23 176



23 178



Nozzle valve

Code	Kw	Voltage	Flow*	Equipment	Weight	Applications	Duty cycle	Warranty	
								Body pump**	Motor***
23 161	-	-	Max 80 L/min	Polypropylene nozzle valve - 1 " GF – NBR seal	0,3 kg	Fuel, diesel	-	-	-
23 171	-	-	Max 100 L/min	Aluminum nozzle valve with swivel joint - 1 " GF – NBR seal	0,8 kg	Fuel, diesel	-	-	-
23 176	-	-	Max 60 L/min	Automatic aluminum nozzle valve with swivel joint - 1 " GF – NBR seal	1,1 kg	Fuel, diesel	-	-	-
23 178	-	-	Max 100 L/min	Automatic aluminum nozzle valve with swivel joint - 1 " GF – NBR seal	1,5 kg	Fuel, diesel	-	-	-

19 514



19 890



23 209



23 156



23 155 958



Accessories

Code	Kw	Volt.	Flow*	Equipment	Wght.	Applications	D. C.	Warranty	
								B. P.**	M.***
19 514	-	-	-	Drum adapter for container in steel/aluminum - connections :G 2 " M-G 1 " M	0,6 kg	Fuel, diesel	-	-	-
19 890	-	-	-	Foot valve in brass with strainer G 1 " F	0,3 kg	Fuel, diesel	-	-	-
23 209	-	-	Max 100 L/min	Diesel filter, water absorbing – 30 um - G 1"1/2 F – Total absorbed water : 130 ml – sealings with grease pre-lubricated	0,6 kg	Fuel, diesel	-	-	-
23 156	-	-	-	Discharge hose diesel DN 25/1,6 m-G 1 " M - G 1 " F with sleeve nut/textile reinforcements/O' ring/operating max pressure 10 bars	1,5 kg	Fuel, diesel	-	-	-
23 155 957	-	-	-	Discharge hose diesel DN19-4 m-G1" M-G1" F w. sleeve nut/textile reinforcements/O' ring/operating max pressure 10 bars	2,6 kg	Fuel, diesel	-	-	-
23 155 958	-	-	-	Discharge hose diesel DN 19-6m-G1" M-G1" F w. sleeve nut/textile reinforcements/O' ring/operating max pressure 10 bars	3,6 kg	Fuel, diesel	-	-	-
23 155 950	-	-	-	Discharge hose diesel DN25- 4 m-G1" M-G1" F w. sleeve nut/textile reinforcements/O' ring/operating max pressure 10 bars	3,4 kg	Fuel, diesel	-	-	-
23 155 956	-	-	-	Discharge hose diesel DN25- 6m-G1" M-G1" F w. sleeve nut/textile reinforcements/O' ring/operating max pressure 10 bars	5,0 kg	Fuel, diesel	-	-	-
23 157 950	-	-	-	Discharge hose diesel DN25-10m-G1" M-G1" F w. sleeve nut/textile reinforcements/O' ring/operating max pressure 10 bars	8,2 kg	Fuel, diesel	-	-	-

* flow rate, free discharge

** outside of worn parts

*** except break out of warranty

Other equipments are available on our website : www.fmtag.ch

Non contractual photography



230V - Fuel management system DMS



23 442
23 447



23 505



23 456
23 476

- Multi users management system
- Easy to use, economic and reliable
- Management up to 1000 users, 50 vehicles /user
- Management of two tanks
- Windows, Mac, linux compatible
- Integrated heating system (-13°)



Outdoor:
Duracryl protection
against sunlight and
weather

DMS - 230V Plate station system management

Code	Kw	Voltage	Flow*	Equipment	Weight	Applications	Duty cycle	Warranty	
								Body pump**	Motor***
23 442	0,37	230V-IP54	56 L/min	DMS diesel management system on Plate pump set with self priming vane pump with bypass – AISI G 1" F – On/Off switch, anti siphoning system – O'ring fittings – LCD (23.505) electronic paddle manual or I buttons - Filtration set 100 L/min – DN19 delivery hose 6m with MF 1" fittings , automatic nozzle valve, control nozzle storage bracket with automatic shutdown – SD card reader– CD ROM software, 7 ibuttons, integrated heating	30 kg	Fuel, diesel	CONTINUOUS	3 years	5 years
23 447	0,5	230V-IP54	100 L/min	DMS diesel management system on Plate pump set with self priming vane pump with bypass – AISI G 1" F – On/Off switch, anti siphoning system – O'ring fittings – LCD (23.505) electronic paddle manual or I buttons - Filtration set 100 L/min – DN25 delivery hose 6m with MF 1" fittings , automatic nozzle valve, control nozzle storage bracket with automatic shutdown – SD card reader– CD ROM software, 7 ibuttons, integrated heating	35 kg	Fuel, diesel	CONTINUOUS	3 years	5 years

DMS - 230V Box filled station system management

23 456	0,37	230V-IP54	56 L/min	DMS diesel management system on box filled station set with self priming vane pump with bypass – AISI G 1" F – On/Off switch, anti siphoning system – O'ring fittings – LCD (23.505) electronic paddle manual or I buttons - Filtration set 100 L/min – DN19 delivery hose 6m with MF 1" fittings , automatic nozzle valve, control nozzle storage bracket with automatic shutdown – SD card reader– CD ROM software, 7 ibuttons, integrated heating, duracryl outside protection	35 kg	Fuel, diesel	CONTINUOUS	3 years	5 years
23 476	0,5	230V-IP54	100 L/min	DMS diesel management system on box filled station set with self priming vane pump with bypass – AISI G 1" F – On/Off switch, anti siphoning system – O'ring fittings – LCD (23.505) electronic paddle manual or I buttons - Filtration set 100 L/min – DN25 delivery hose 6m with MF 1" fittings , automatic nozzle valve, control nozzle storage bracket with automatic shutdown – SD card reader– CD ROM software, 7 ibuttons, integrated heating, duracryl outside protection	40 kg	Fuel, diesel	CONTINUOUS	3 years	5 years

DMS - Diesel management system

23 505	-	-	Max 100 L/min	LCD 5" electronic paddle DMS – aluminum housing – for 2 distributors – Identification code or I buttons, software for distance and stock – 2GO memory with SD card with reader – CR ROM software – statistics menu – Multilanguage.	2,3 kg	Fuel, diesel	Up to 1000 users	-	-
--------	---	---	---------------	---	--------	--------------	------------------	---	---

* flow rate, free discharge

** outside of worn parts

*** except break out of warranty

Other equipments are available on our website : www.fmtag.ch

Non contractual photography

Mobifitt-Mobimaster mobile tanks 125 to 450 Liters UN/ADR norm



mobIMASTER®

mobiFITT



Outdoor :
Resistant
UV protection



- A qualitative range of mobile UN/ADR plastic tanks
- Absolute safe re-filling
- Compact, easy to use, easy to carry
- High quality assembling
- Continuous operation pumps
- Not suitable for gasoline.

ADR Mobifitt mobile tanks : 125 – 200 – 300 liters

Code	Kw	Voltage	Flow*	Equipment	Weight	Applications	Packaging (LxHxh)	Capacity	Warranty**
26 440	0,22	12V-IP54	35 L/min	UN/ADR 125 liters HDPE mobile tank - closable cover with key – self priming vane pump with bypass – AISI G 1" F – On/Off switch, anti siphoning system – O'ring fittings - DN19 delivery hose 4m with MF 1 " fittings , automatic nozzle valve – dipstick, filler cap, security suction valve.	30 kg	Fuel, diesel	1002x654x369	125 liters	5 years
26 441	0,32	24V-IP54	35 L/min	UN/ADR 125 liters HDPE mobile tank – closable cover with key – self priming vane pump with bypass – AISI G 1" F – On/Off switch, anti siphoning system – O'ring fittings - DN19 delivery hose 4m with MF 1 " fittings , automatic nozzle valve – dipstick, filler cap, security suction valve.	30 kg	Fuel, diesel	1002x654x369	125 liters	5 years
26 460	0,22	12V-IP54	35 L/min	UN/ADR 200 liters HDPE mobile tank – closable cover with key – self priming vane pump with bypass – AISI G 1" F – On/Off switch, anti siphoning system – O'ring fittings - DN19 delivery hose 4m with MF 1 " fittings , automatic nozzle valve – dipstick, filler cap, security suction valve.	35 kg	Fuel, diesel	1010x654x534	200 liters	5 years
26 461	0,32	24V-IP54	35 L/min	UN/ADR 200 liters HDPE mobile tank – closable cover with key – self priming vane pump with bypass – AISI G 1" F – On/Off switch, anti siphoning system – O'ring fittings - DN19 delivery hose 4m with MF 1 " fittings , automatic nozzle valve – dipstick, filler cap, security suction valve.	35 kg	Fuel, diesel	1010x654x534	200 liters	5 years
26 480	0,22	12V-IP54	35 L/min	UN/ADR 300 liters HDPE mobile tank – closable cover with key – self priming vane pump with bypass – AISI G 1" F – On/Off switch, anti siphoning system – O'ring fittings - DN19 delivery hose 4m with MF 1 " fittings , automatic nozzle valve – dipstick, filler cap, security suction valve.	40 kg	Fuel, diesel	997x654x703	300 liters	5 years
26 481	0,32	24V-IP54	35 L/min	UN/ADR 300 liters HDPE mobile tank – closable cover with key – self priming vane pump with bypass – AISI G 1" F – On/Off switch, anti siphoning system – O'ring fittings - DN19 delivery hose 4m with MF 1 " fittings , automatic nozzle valve – dipstick, filler cap, security suction valve.	40 kg	Fuel, diesel	997x654x703	300 liters	5 years

ADR Mobimaster mobile tanks : 450 liters

26 400	0,22	12V-IP54	35 L/min	UN/ADR 450 liters HDPE mobile tank – closable cover with key – self priming vane pump with bypass – AISI G 1" F – On/Off switch, anti siphoning system – O'ring fittings - DN19 delivery hose 4M with MF 1 " fittings , automatic nozzle valve– dipstick, filler cap, security suction valve.	50 kg	Fuel, diesel	1190x800x900	450 liters	5 years
26 401	0,32	24V-IP54	35 L/min	UN/ADR 450 liters HDPE mobile tank – closable cover with key – self priming vane pump with bypass – AISI G 1" F – On/Off switch, anti siphoning system – O'ring fittings - DN19 delivery hose 4M with MF 1 " fittings , automatic nozzle valve– dipstick, filler cap, security suction valve.	50 kg	Fuel, diesel	1190x800x900	450 liters	5 years
26 402	0,38	12V-IP54	60 L/min	UN/ADR 450 liters HDPE mobile tank – closable cover with key – self priming vane pump with bypass – AISI G 1" F – On/Off switch, anti siphoning system – O'ring fittings - DN19 delivery hose 4M with MF 1 " fittings , automatic nozzle valve– dipstick, filler cap, security suction valve.	53 kg	Fuel, diesel	1190x800x900	450 liters	5 years
26 403	0,67	24V-IP54	60 L/min	UN/ADR 450 liters HDPE mobile tank – closable cover with key – self priming vane pump with bypass – AISI G 1" F – On/Off switch, anti siphoning system – O'ring fittings - DN19 delivery hose 4M with MF 1 " fittings , automatic nozzle valve– dipstick, filler cap, security suction valve.	53 kg	Fuel, diesel	1190x800x900	450 liters	5 years
26 410	0,22	12V-IP54	35 L/min	UN/ADR 450 liters HDPE mobile tank – closable cover with key – self priming vane pump with bypass – AISI G 1" F – On/Off switch, anti siphoning system – O'ring fittings – NEF digital meter - DN19 delivery hose 4M with MF 1 " fittings , automatic nozzle valve– dipstick, filler cap, security suction valve.	54 kg	Fuel, diesel	1190x800x900	450 liters	5 years
26 411	0,32	24V-IP54	35 L/min	UN/ADR 450 liters HDPE mobile tank – closable cover with key – self priming vane pump with bypass – AISI G 1" F – On/Off switch, anti siphoning system – O'ring fittings – NEF digital meter - DN19 delivery hose 4M with MF 1 " fittings , automatic nozzle valve– dipstick, filler cap, security suction valve.	54 kg	Fuel, diesel	1190x800x900	450 liters	5 years
26 412	0,38	12V-IP54	60 L/min	UN/ADR 450 liters HDPE mobile tank – closable cover with key – self priming vane pump with bypass – AISI G 1" F – On/Off switch, anti siphoning system – O'ring fittings – NEF digital meter - DN19 delivery hose 4M with MF 1 " fittings , automatic nozzle valve– dipstick, filler cap, security suction valve.	58 kg	Fuel, diesel	1190x800x900	450 liters	5 years
26 413	0,67	24V-IP54	60 L/min	UN/ADR 450 liters HDPE mobile tank – closable cover with key – self priming vane pump with bypass – AISI G 1" F – On/Off switch, anti siphoning system – O'ring fittings – NEF digital meter - DN19 delivery hose 4M with MF 1 " fittings , automatic nozzle valve– dipstick, filler cap, security suction valve.	58 kg	Fuel, diesel	1190x800x900	450 liters	5 years

* flow rate, free discharge

** warranty beginning after the sale by FMT

Other equipments are available on our website : www.fmtag.ch

Non contractual photography



Fluid Management Technologies Swiss AG

Sylvain Pelegris

Business Development Manager

Gewerbestrasse 6

6330 Cham (Switzerland)

Tel : +33 (0) 615 54 39 59

Mail : sylvain.pelegris@fmtag.ch

www.fmtag.ch

